

# AQUA-BASE<sup>®</sup>

watermakers

by SLCE

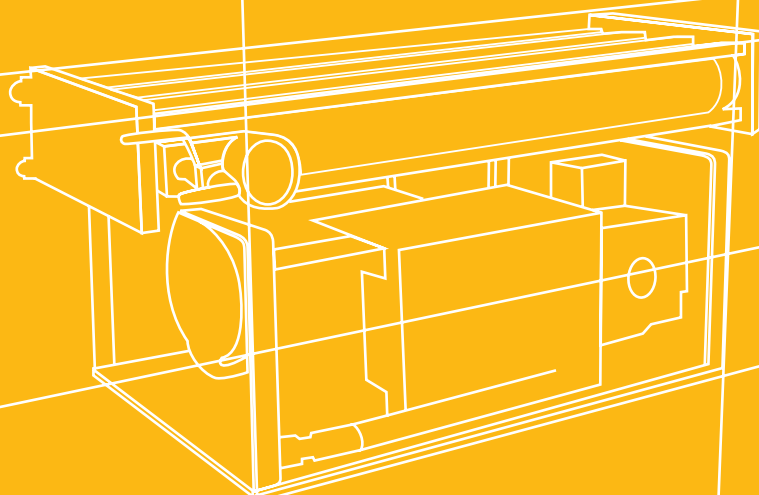

**From 30 to 300 litres per hour**

## Aqua-Base<sup>®</sup>X

from 30  
to 90 L/h

Yachting

Very compact watermakers specifically designed for small boats where available energy and space are limited.

### Specifications

- Battery powered or generator
- Low pressure seawater feed pump
- High pressure CAT pump
- High rejection rate membranes
- 5 Micron filter
- High pressure safety switch
- Pressure regulation valve
- High pressure gauges
- Salinometer and automatic diversion valve



### Options

- Remote control
- Automatic flushing
- Separation kit

X

X in a frame

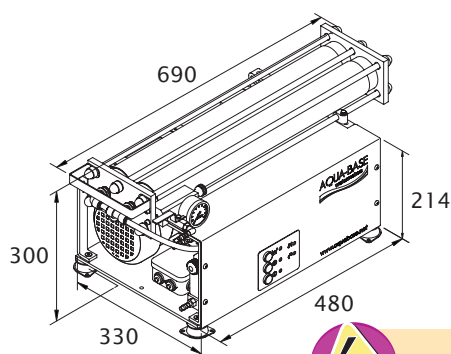

X

X with separation option

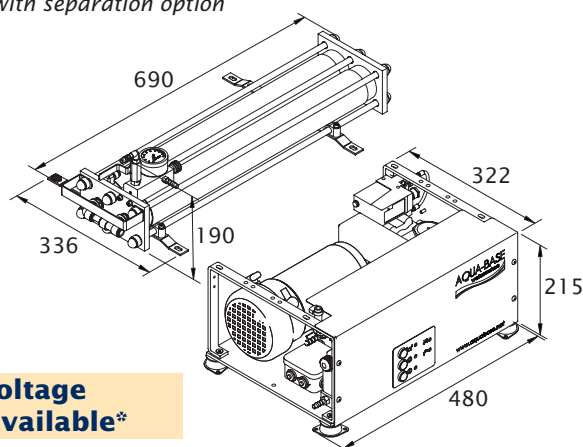

**Dual voltage  
models available\***

| Capacity | Model         | Voltage |              |             | Electricity Consumption | Weight |
|----------|---------------|---------|--------------|-------------|-------------------------|--------|
|          |               | Battery | Single phase | Three phase |                         |        |
| 30 L/h   | <b>XD121*</b> | 12 V    | -            | -           | 31 A                    | 34 kg  |
|          | <b>XD241*</b> | 24 V    | -            | -           | 25 A                    | 36 kg  |
|          | <b>XA221</b>  | -       | 230 or 115 V | -           | 1 kW                    | 38 kg  |
| 50 L/h   | <b>XD122*</b> | 12 V    | -            | -           | 31 A                    | 40 kg  |
| 60 L/h   | <b>XD242*</b> | 24 V    | -            | -           | 25 A                    | 42 kg  |
|          | <b>XA222</b>  | -       | 230 or 115 V | -           | 1 kW                    | 44 kg  |
| 90 L/h   | <b>XA223</b>  | -       | 230 or 115 V | -           | 1 kW                    | 50 kg  |

Rated performances +/- 10% using standard seawater, with 35 g/l salinity and temperature at 25°C.

\*Dual voltage models available : 12/230V or 24V/230V.

Very simple to install and use, AQUA-BASE® watermakers are delivered complete with an installation kit and detailed instructions.  
All AQUA-BASE® watermakers are certified by Bureau Veritas.



## Aqua-Base®Y

from 60  
to 300 L/h

Yacht  
Charter  
Professional  
Boat

Heavy-duty design watermakers recommended for intensive users.



### Specifications

- Tri-phase or single phase electricity feed
- Low pressure seawater feed pump
- High pressure CAT pump
- High rejection rate membranes
- 5 & 20 Micron filters
- High and low pressure safety switches
- Pressure regulation valve
- High and low pressure gauges
- Salinometer and automatic diversion valve
- Hour meter
- Flow meter

### Options

- Remote control
- Automatic flushing
- Sand filter

YC

Y in a frame

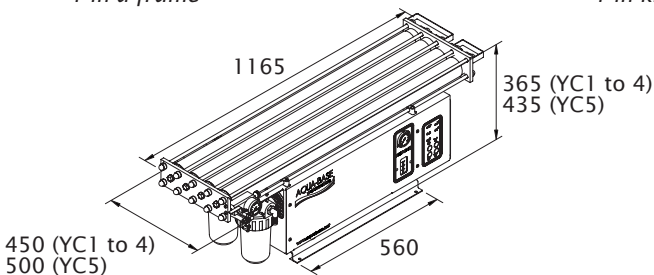

YK

Y in kit form

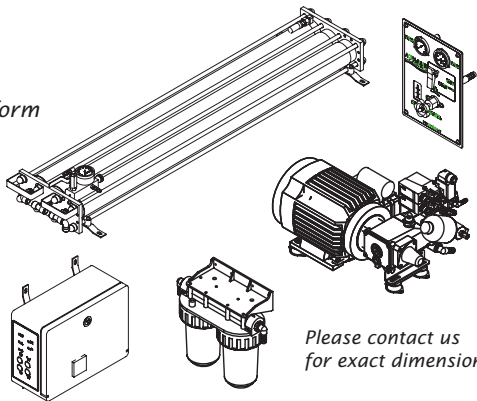

Please contact us for exact dimensions

| Capacity | Model | Voltage |              |              | Electricity Consumption | Weight |
|----------|-------|---------|--------------|--------------|-------------------------|--------|
|          |       | Battery | Single phase | Three phase  |                         |        |
| 60 L/h   | YC1   | -       | 230 or 115 V | 400 ou 220 V | 1,5 kW                  | 61 kg  |
|          | YK1   | -       |              |              |                         | 52 kg  |
| 120 L/h  | YC2   | -       | 230 or 115 V | 400 ou 220 V | 1,5 kW                  | 69 kg  |
|          | YK2   | -       |              |              |                         | 60 kg  |
| 180 L/h  | YC3   | -       | 230 or 115 V | 400 ou 220 V | 2 kW                    | 77 kg  |
|          | YK3   | -       |              |              |                         | 68 kg  |
| 240 L/h  | YC4   | -       | 230 or 115 V | 400 ou 220 V | 2 kW                    | 85 kg  |
|          | YK4   | -       |              |              |                         | 76 kg  |
| 300 L/h  | YC5   | -       | 230 V        | 400 ou 220 V | 3 kW                    | 95 kg  |
|          | YK5   | -       |              |              |                         | 86 kg  |

Rated performances +/- 10% using standard seawater, with 35 g/l salinity and temperature at 25°C. Other voltages on request.



## Aqua-Base®Eco

from 35  
to 150 L/h

Low  
energy  
consumption

Energy recovery watermakers designed for boats  
where energy available is very limited.



**Only 12 Amps at 12 Volts  
to produce 35 litres/hour**

Two versions are available :

- **ESB** : Basic manual version.
- **ESW** : Automatic version,  
includes automatic salinity control.

### Specifications

- Low-pressure seawater feed pump
- Desalination module
- 5 Micron filter

### Options

- Remote control (ESW)
- Automatic flushing (ESW)
- Dual voltage



**Dual voltage  
models available\***

### ESB/ESW

35 et 65 L/h

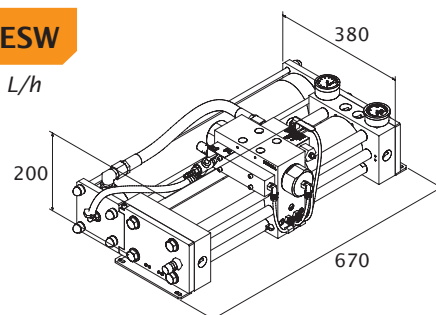

### ESW

105 L/h

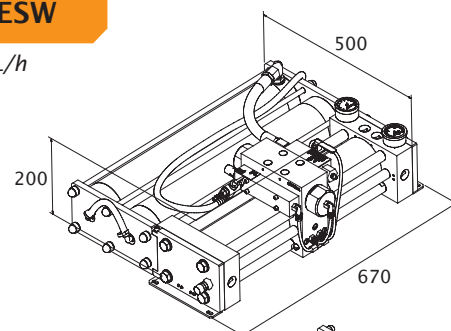

### ESW

150 L/h

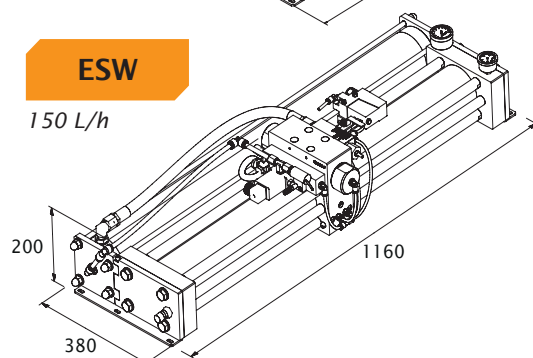

| Capacity | Model              | Voltage |              | Electricity<br>Consumption | Weight |
|----------|--------------------|---------|--------------|----------------------------|--------|
|          |                    | Battery | Single phase |                            |        |
| 35 L/h   | <b>ESB/ESW301*</b> | 12 V    | -            | 12 A                       | 41 kg  |
|          | <b>ESB/ESW302*</b> | 24 V    | -            | 6 A                        | 41 kg  |
| 65 L/h   | <b>ESB/ESW601*</b> | 12 V    | -            | 25 A                       | 49 kg  |
|          | <b>ESB/ESW602*</b> | 24 V    | -            | 12,5 A                     | 49 kg  |
| 105 L/h  | <b>ESW901*</b>     | 12 V    | -            | 34 A                       | 63 kg  |
|          | <b>ESW902*</b>     | 24 V    | -            | 17 A                       | 63 kg  |
| 150 L/h  | <b>ESW1502*</b>    | 24 V    | -            | 34 A                       | 110 kg |
|          | <b>ESW1503</b>     | -       | 230 V        | 1 kW                       | 110 kg |

Rated performances +/- 10% using standard seawater, with 35 g/l salinity and temperature at 25°C.

\*Dual voltage models available : 12/230V or 24V/230V.

# Aqua-Base® reliability and service

## AQUA-BASE® offers two technologies for the desalination of sea water :

- Our standard technology range, using a high pressure pump, with capacities from 30 L/h to 300 L/h.
- Our ECO range, with energy recovery technology, with capacities from 35 L/h to 150 L/h.

Designed and built by SLCE, the AQUA-BASE® range is complete, simple and reliable. AQUA-BASE® only uses the finest quality materials and components in its manufacturing processes.

AQUA-BASE® machines are subject to rigorous and lengthy testing, carried out on a permanent basis by SLCE's Quality Assurance Service. Some assembly-line machines undergo intense trials, which can last for more than 10,000 hours. This testing qualifies AQUA-BASE® for "Bureau Veritas" certification.

Naturally, AQUA-BASE® benefits from SLCE's world-wide sales and technical assistance service.

## AQUA-BASE® Standard Technology models

- Compact machines supplied either in a frame or in kit form for fitting into any situation,
- Everything required is supplied as standard, with automatic salinity control of the produced water, and an installation kit,
- Simple and easy to use control panel,
- Excellent accessibility for simple and easy maintenance.

## AQUA-BASE® Energy Recovery (ECO) Models

### The concept

The traditional high-pressure pump, the main energy user, is replaced by a hydraulic amplifier system fed by a low pressure pump. This patented technology is applied by SLCE to the AQUA-BASE ECO range: it is simple and economical.

### Advantages

- **Very low energy consumption:** only 12 A at 12 volts to produce 35 L/h
- **Remarkably quiet:** less than 64 dbA at 1m distance
- **Total absence of vibration**
- **Simple to use:** no need to adjust pressures. Entirely hydraulically operated, the machine is automatically self-regulating according to operating conditions
- **Very easy installation:** on the floor, on a wall, on a ceiling, vertically or horizontally
- **Simplified maintenance:** no need to change pump oil
- **Optimised membrane life** by always operating in ideal conditions: SLCE's endurance testing shows that its lifespan exceeds 10, 000 hours

### Optional extras:

- **Remote control:** integrates the unit's command and control functions
- **Automatic rinsing:** allows Fresh water rinsing of the membranes
- **Sand filter:** available on the Y range, improves pre-filtration and prolongs the life of the pre-filters
- **Dual voltage (DC and AC):** available on the ECO and XD ranges, allows alternative electricity supply, either generator or battery



# AQUA-BASE®

watermakers

149 rue Salvador Dali  
ZA de Kergouaran - Caudan  
CS 8002  
56607 LANESTER Cedex  
France



tel. +33(0)297 838 888  
fax +33(0)297 838 333  
e-mail [slce@slce.net](mailto:slce@slce.net)  
internet [www.aquabase.net](http://www.aquabase.net)



Your contact

AQUA-BASE® is a trademark of SLCE