



Hella marine
Vision and Innovation



Latest additions to the Hella marine range



New !

Sea Hawk-R

LED Floodlights

LED Sea Hawk-R

7w 550 Lumen

Compact, high performance LED floodlights



Future technology has been applied to the successful Sea Hawk series for class leading efficiency and guaranteed durability.

Hi-tech materials

Sea Hawk-R housings are 'Non-metal', injection moulded from a revolutionary thermally conductive polymer that is highly resistant to degradation, even under harsh UV.

This advanced material draws heat away from internal electronics for reliable long-term operation. Utilising thermal polymer eliminates the requirement for a aluminium housing in this class of floodlight, removing potential surface deterioration and material corrosion risks associated with coated metal in the harsh marine environment.

The lens is precision moulded from high performance Grilamid® for strength and durability.

Multivolt™ 9-33V DC

Advanced electronics ensure reliable illumination and lamp protection even under severe voltage fluctuations and low battery voltages.

Engineered light pattern

Sophisticated optics deliver a broad and even illumination without glare or harsh point sources. Specifically developed to illuminate a wide, close-range spread over a cockpit, foredeck or working area.

Pre-wired with twin core marine cable

High quality sealed cable assemblies for time saving, completely sealed installations.

Designed and manufactured in New Zealand

Sea Hawk lamps carry a 5 year warranty.

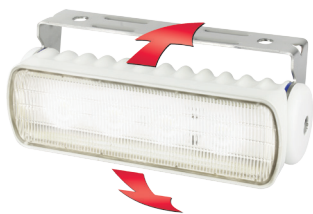

Friction mounts allow adjustment without tools.



Completely sealed lamp and cable entry.
Polished 316 stainless steel bracket.



Sea Hawk-R Candela and Lux performance.

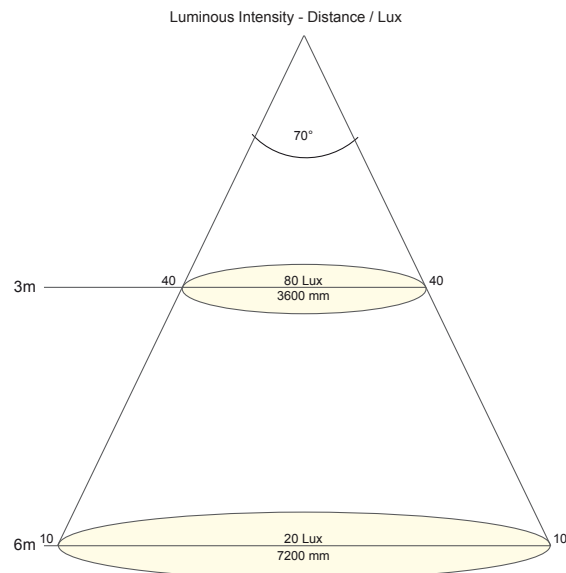
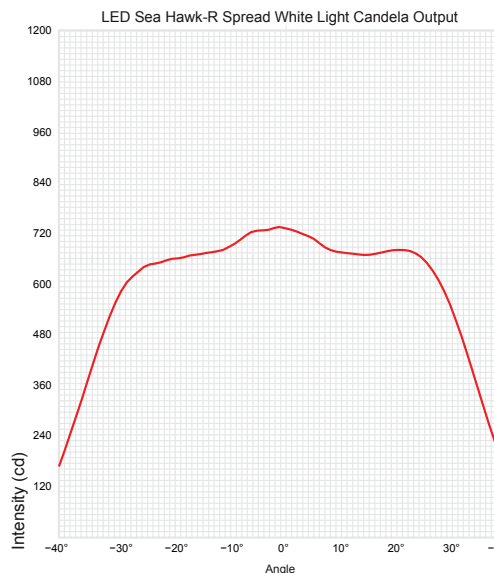

Hella marine Sea Hawk-R series. Compact, high performance LED floodlights



Packaging for
aftermarket presentation

| | |
|-----------------------------|---|
| Material Description | 'Non metal' thermally conductive polymer housing Heavy duty Grilamid® lens |
| Bracket | Polished 316 stainless steel |
| Colour Temperature | 5000K (White) / 3000K (Warm White) |
| Cable | Pre-wired with 0.5m of twin core marine cable |
| Operating Voltage | Multivolt™ 9-33V DC |
| Degree of Protection | IP 67 - Completely Sealed |
| Power Consumption | 7W (0.58A@12V / 0.29A@24V) |
| Weight | 250g (including cable) |
| Light Output | 550 lumens (White) / 380 lumens (Warm White) |
| Approvals | CE, C-Tick |

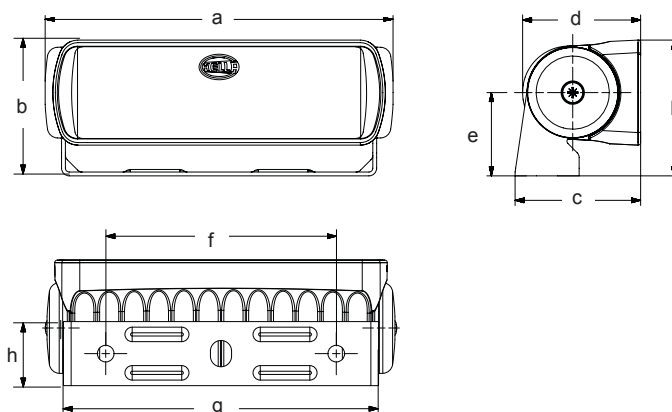

| Dimensions | |
|------------|---------|
| a = 136mm | / 5.35" |
| b = 53.0mm | / 2.08" |
| c = 49.0mm | / 1.93" |
| d = 46.0mm | / 1.81" |
| e = 32.5mm | / 1.28" |
| f = 90.0mm | / 3.54" |
| g = 123mm | / 4.84" |
| h = 25.0mm | / 0.98" |

Sea Hawk-R Bracket Mount

LED
Multivolt

White Light LED Floodlights - Spread

| Voltage | Housing Colour | Part Number |
|----------|----------------|-----------------|
| 9-33V DC | Black Housing | 2LT 980 573-011 |
| 9-33V DC | White Housing | 2LT 980 573-021 |



LED
Multivolt

Warm White Light LED Floodlights - Spread

| Voltage | Housing Colour | Part Number |
|----------|----------------|-----------------|
| 9-33V DC | Black Housing | 2LT 980 573-051 |
| 9-33V DC | White Housing | 2LT 980 573-061 |

