



open  
SYSTEM



Opem Sistemi S.r.l.  
Via Sardorella, 101  
16162 Genova  
Tel. +39.010 6001292  
Fax +39.010 6014641  
E-mail: [info@opemsistemi.it](mailto:info@opemsistemi.it)

# INDEX

WHO WE ARE .....	p.05
PRODUCTS	
ANCHOR WINDLASSES .....	p.07
MOORING CAPSTANS .....	p.09
STEERING SYSTEMS .....	p.11
ELECTRIC STEERING SYSTEMS (SYES®) .....	p.13
TRIM TABS .....	p.17
SERVICE .....	p.19
OUR FACILITY .....	p.20
OUR MAIN CUSTOMERS .....	p.22



## WHO WE ARE

### FROM DESIGN TO SERVICE

OPEM SISTEMI manufactures naval equipment for Megayacht, Military Vessels (Coast Guard and Patrol Boats, Harbour and Customs Craft), small and medium size Passenger Vessel, Work and Fishing boats.

Design and manufacture features of OPEM SISTEMI products meet the main Classification Societies' regulations as well as different Customers' requirements (Customer Design). OPEM SISTEMI provides complete technical and installations drawings and its technical assistance department is able to grant the best support to the Customer during installation, commissioning, trials and life of its systems.



## ANCHOR WINDLASSES

DESIGN - QUALITY - RELIABILITY

OPEM SISTEMI manufactures Anchor Windlasses for chain from 14 to 50 mm, double of variable speed, two directions. Typical equipment refers to a couple of symmetrical anchor capstans, having vertical axis. Each deck unit is equipped with proper electric device, like frequency drive and control unit, in a way each unit is independent from the other one. Hydraulic version is also available.

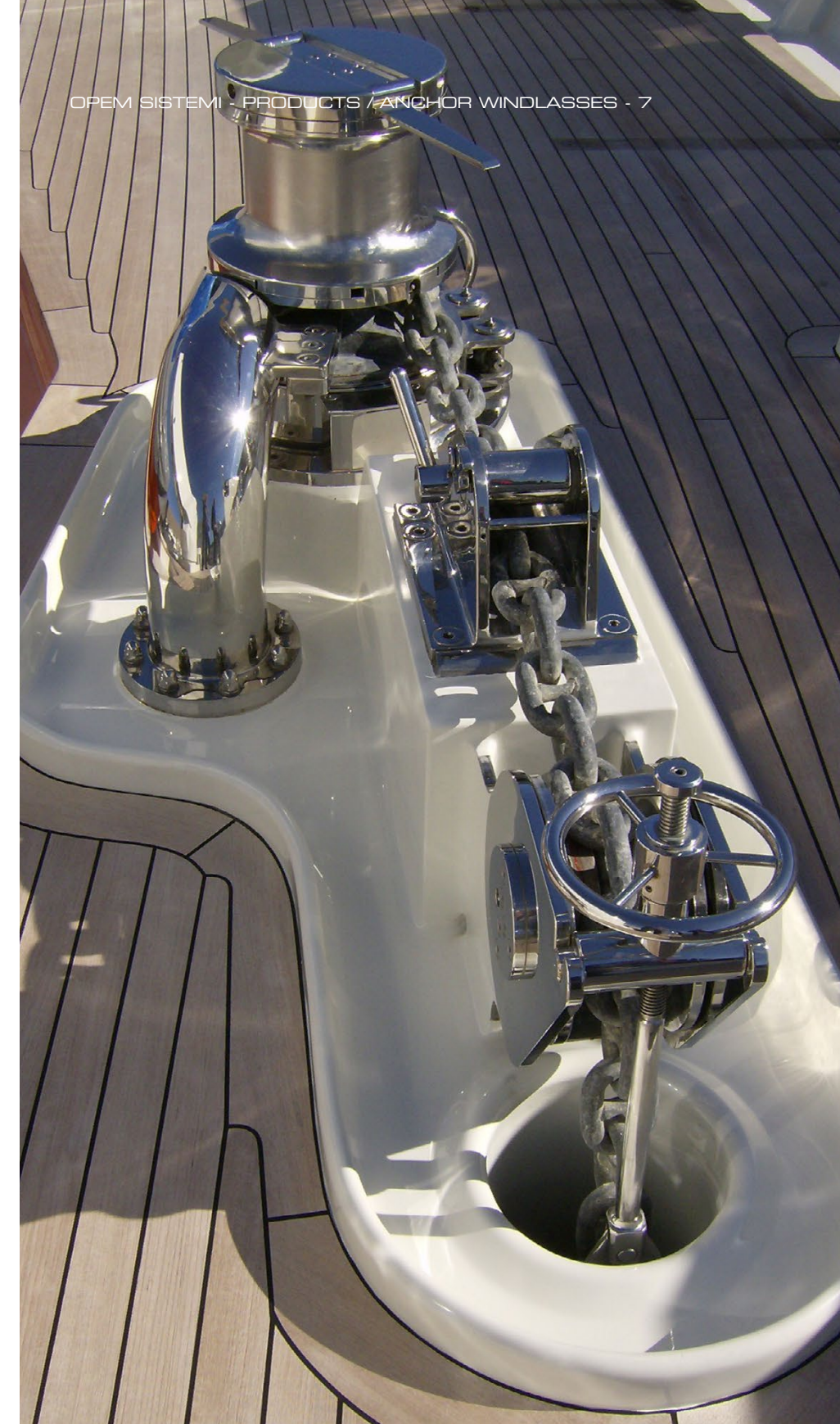
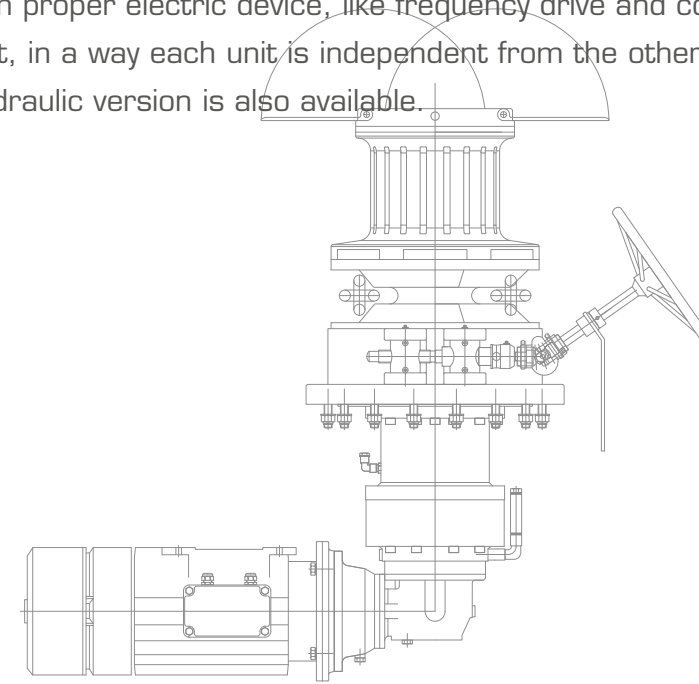

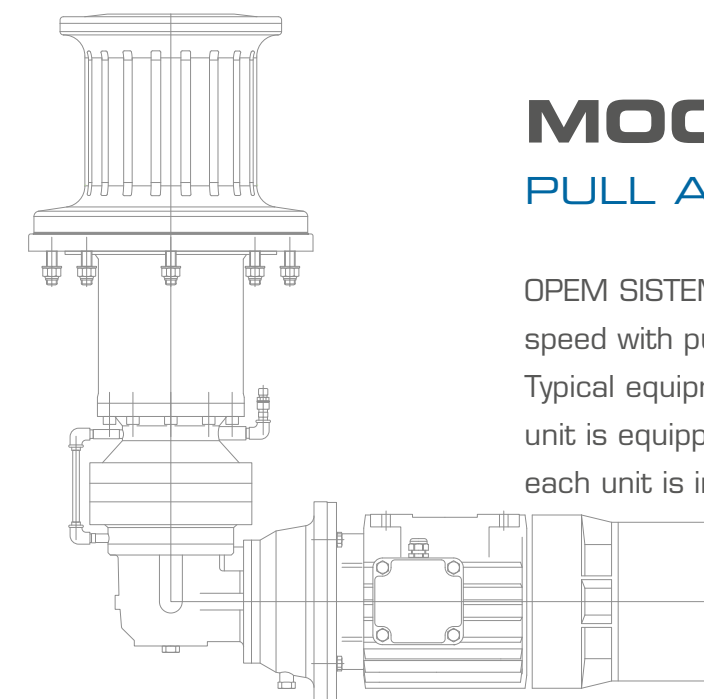

## MOORING CAPSTANS

### PULL AND AESTHETIC

OPEM SISTEMI manufactures electric and hydraulic mooring capstans, single or variable speed with pull up to more than 5 T.

Typical equipment is made of a couple of mooring capstans, with vertical axis. Each deck unit is equipped with proper electric device, like frequency drive and control unit, in a way each unit is independent from the other one. Hydraulic version is also available.

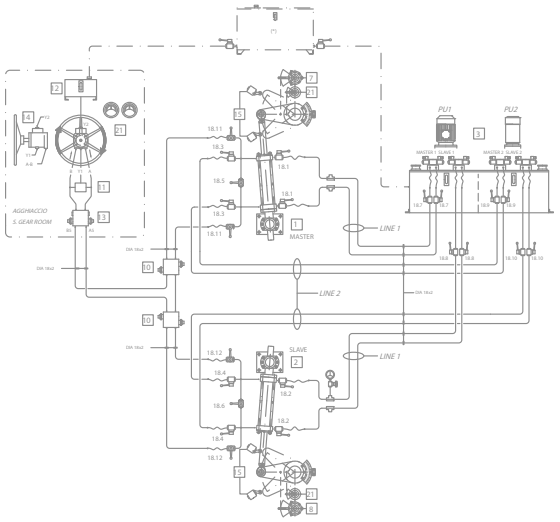
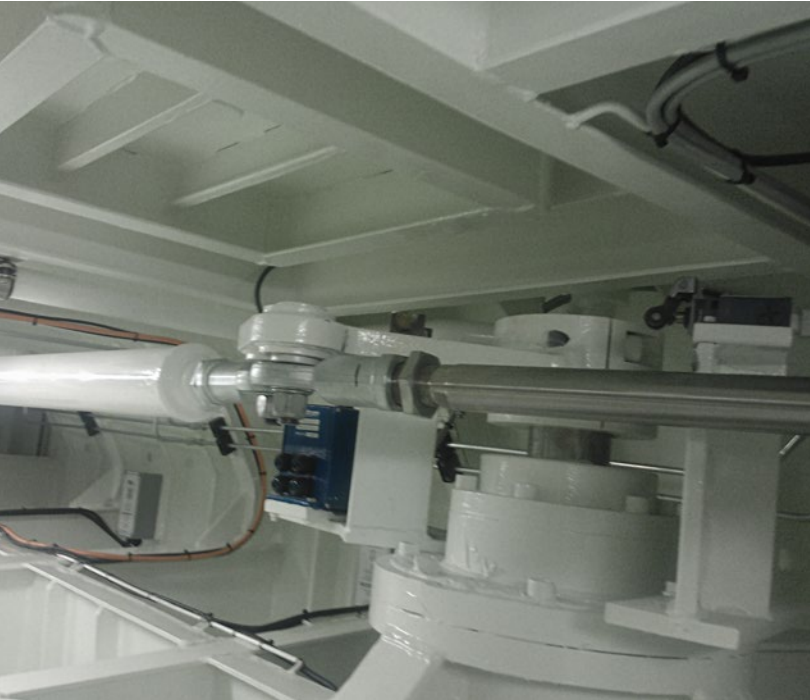

# STEERING SYSTEMS

KEEP YOUR ROUTE

OPEM SISTEMI designs and produces Steering Systems from 300 daNm up to 20.000 daNm according to the rules of the main Classifications Societies. Steering Systems are electro hydraulic type (Follow Up/Non Follow Up/Emergency) and can be mechanically or electrically synchronized. Electronic control and alarm systems grant the best reliability and can be easily linked to every “integrated bridge system”.

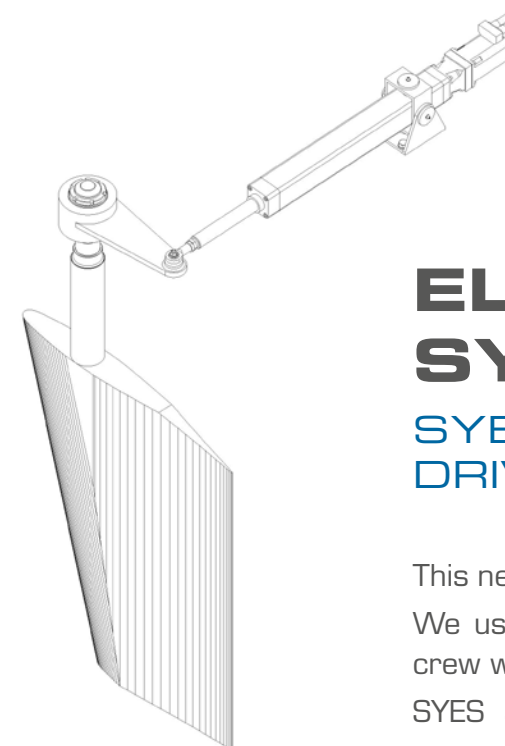
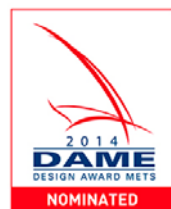

## ELECTRIC STEERING SYSTEM (SYES®)

SYES IS A CUTTING EDGE STEERING SYSTEM DRIVEN BY ELECTRIC ACTUATOR

This new technology is suitable for every type of vessel equipped with single or twin rudder. We usually provide two electric actuators electronically synchronized. If one stops the crew will be able to steer the vessel with the second.

SYES also includes a very innovative emergency steering device which complies to classification rules.

## HIGHLIGHTS OF (SYES®)

### SYES IS A CUTTING EDGE STEERING SYSTEM DRIVEN BY ELECTRIC ACTUATOR

#### **Simplicity of installation**

Installation of SYES electric actuator is easier than a hydraulic cylinder of common use.

#### **Economy of installation**

You no longer need the power pack, then you will be able to avoid laying pipes.

#### **Green installation**

You no longer need oil to run a steering system thus totally avoiding the risk of leak and pollution. The direct electric drive is more efficient than an electro hydraulic drive helping to save fuel from the generators and consequently lowering the CO2 production and the polluting emissions in general.

#### **Flexibility**

In case of dual rudder system, SYES can be fitted either way with or without connecting bar granting a precise control thus avoiding the offsets which very often occur to the hydraulic steering systems.

#### **Versatility**

Precise and versatile electronic control to be interfaced with different steering modes: FU, NFU and Autopilot. Particularly suitable also for automatic features like limiting the speed or excursion of the rudders beyond a certain speed of the vessel, or for the use of the rudders also independently for maneuvering or for dynamic positioning.



The electrical unit consists of an electric linear actuator, commonly called electro cylinder with a push/pull rod connected to one end of the bar by a support with ball joint. The actuator is fitted to the boat's structure through a cardan joint. Gimbals as well as the ball joints will be useful to compensate for small alignment errors that might occur during installation.

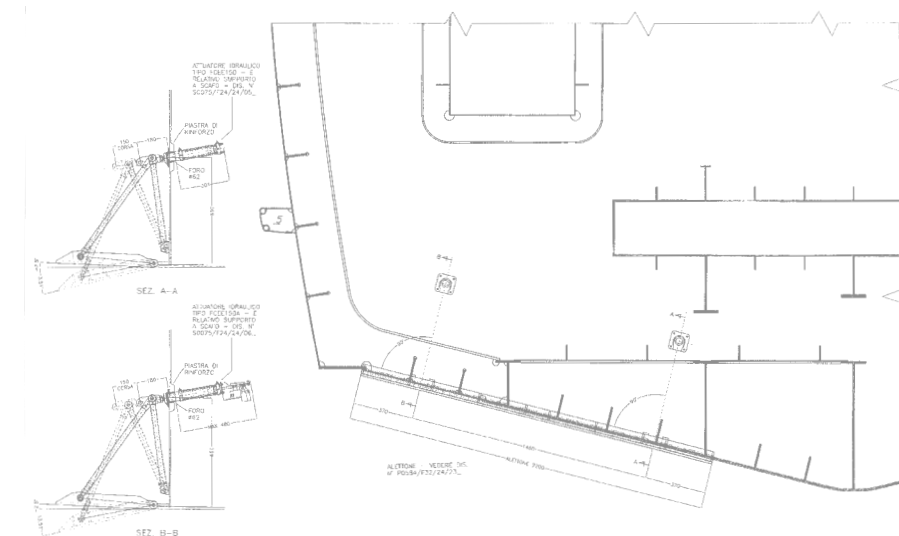

## TRIM TABS

## RIDE THE WAVES

OPEM SISTEMI produces a complete range of trim tabs suitable for Megayachts, Military Craft (Coast Guards, Patrol Boats) and high speed Passenger Vessels.

Typical equipment includes:

- N. (2) AISI 316 stainless steel (or casting aluminium) tabs
- N. (2) Double acting cylinder actuators
- N. (2) Independent power unit
- Control system
- Tab angle indicator
- Installation drawing and operator's manual



## SERVICE

### CARE AND CONFORT

OPEM SISTEMI manufactures all the components in house and takes directly care of the maintenance and repair with its service team and with the support of its international partners.

#### SPARES AND STOCK

The electronic parts are mostly chosen “off the shelf” from primary brands in order to have the maximum availability world wide. Main components are manufactured on CNC precision machinery at our own state-of-the-art OPEM SISTEMI manufacturing facility, and assembled and tested on our test equipment. Spares for production models are normally stocked, or may be fabricated to suit field service requirements. OPEM SISTEMI stocks in excess of some hundred thousand euros of standard product inventory.







**OPEM SISTEMI S.R.L.**

Via Sardorella, 101

16162 Genova

Tel. +39.010 6001292

Fax +39.010 6014641

E-mail: [info@opemsistemi.it](mailto:info@opemsistemi.it)